



Installation Guide

Acoustic Wall Panel

Contents

Preface	2
Adhesive Method	3
Fast Mount Method	4
Adhesive Method	5
Direct Fix Method	6
Magnet Method	7





Wall Preparation

Before beginning the installation process, ensure that the wall is clean (free of any dust, flaking paint, loose debris or grime), structurally sound, dry and free of imperfections.

Important Notes

When cutting and fitting panels to fit the space, consider which areas of the wall will contain the cut portions and try to apply the products as symmetrically as possible. It may help to measure and mark the space beforehand.

Printed Panels

Ensure that all Acoufelt QuietPrint Panels are installed at the correct orientation as provided by the Acoufelt print and installation plan to avoid any variation in pattern that may impact the overall look of the finished installation.

Adhesive Method

Tools & materials required:

- Clean gloves
- Utility knife
- Straight edge
- Measuring tape
- Caulking gun
- Liquid Nail Adhesive
- Roller

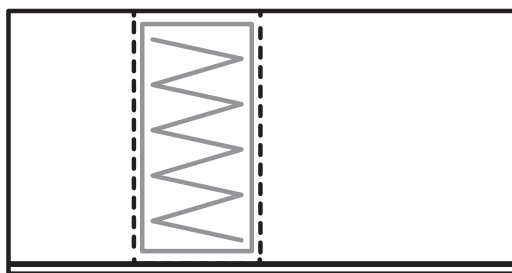

- Wall perimeter
- - - Panel installation area
- Adhesive
- ▬ Skirting board

Steps:

1. Read all installation instructions prior to installing.
2. Wear clean white gloves throughout the installation process.
3. After preparing the wall for installation, dry fit (without adhesive) the panels to the wall. Measure the panels and the wall and ensure they are straight and line up. If required, use the utility knife and the straight edge to accurately cut the panels to the appropriate dimensions.
4. All panels are labelled with a sticker indicating the back of the panel.
5. Using the caulking gun and liquid nails, apply the adhesive around the inner edge of the wall to be covered up by the panel. To avoid adhesive flowing through the joints when the panels are installed, apply the adhesive two finger widths away from the wall corner/join, then apply adhesive in a zig zag pattern across the centre of the application area, as shown in the diagram on the left.
6. Keeping the wall panel as straight as possible, press the underside of the panel onto the wet adhesive. Apply even pressure with the roller and firmly press all areas of the panel to the wall.
7. Wipe away any leaked or excess adhesive from the panel before beginning the adjoining panel. Avoid any adhesive making contact with face of the panel.
8. Trim off any excess material around joints, pipes, sockets etc.



Fast Mount Method

The VL-03 and VL-03H are ideal for mounting ceiling and wall panels in areas with minimal frame and panel thickness. The VL-03 and VL-03H clip sets use the patented Super Groove system to mechanically engage into adhesive. Screw or adhesive combinations can be used.

If concerned about the screw holding in the panel apply a small amount of Construction adhesive to the screw prior to inserting into the panel.

Link to the video on how to install the Fast Mount:
<https://vimeo.com/66858904>

Tools & materials required:

- Clean gloves
- Utility knife
- Straight edge
- Measuring tape
- Drill
- #8 Screws
- Fast Mount Wall Clips
- Fast Mount Navigation Keys
- Liquid Nails Adhesive*
- VL-03 Set- 5KG
- VL-03H Set - 10KG



Steps: For Adhesive Method

- Using the drill, screw the side without the insulated cover into the panel. For a 12mm/1/2" panel it is recommended to use 2 clip sets for every 2.4m²/ 8 ft² so if you are applying to a standard full-size panel apply 8 clips to the edges of the panels.
- All panels are labelled with a sticker identifying the back of the panel.
- On the surface the panel is being installed onto, drill a 25mm/1" hole 7mm/0.28" deep
- Apply liquid nails adhesive or Fastmount SuperGroove CT-5010 Adhesive to VL-F3
- Fit the VL-F3 or VL-F3H clip according to the weight you are hanging. Adhesive will engage onto the supergrooves in clip base, allow the adhesive to cure.
- Insert VL-CP3 into the VL-F3 or VL-F3H clip. This will then mark the drill spot on the back of the panel.
- Drill a 4mm/0.16" hole, 5mm/0.2" deep (with CT-09 bit) on the mark that has been created. Repeat this step for all locations of the Fast Mount Clips.
- Adjust the clutch of the drill to prevent over tightening.
- Screw VL-M3 with VL-SS3 (Screw) into the panel. Screw allows lateral movement of VL-M3.
- Fit clips at maximum 300mm/11.8" centres on the panel.
- Bring panel to the wall. Position Fast Mount clips to press and lock the clip.

Exploded view of typical installation (adhesive Fix)

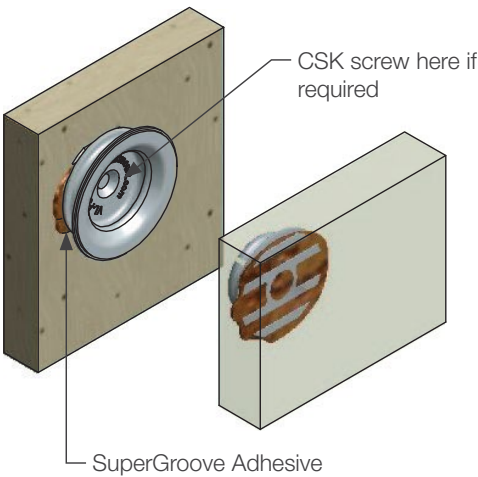

Section through installed Clip

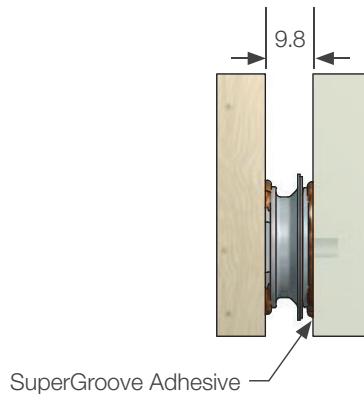

Exploded view showing centre point marker, install option

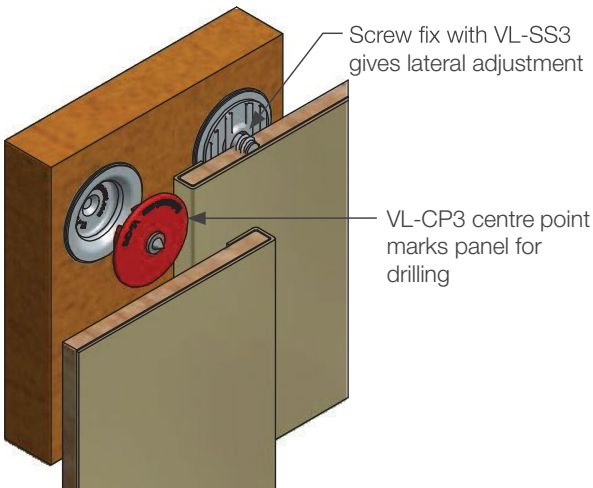

Section through recessed installation

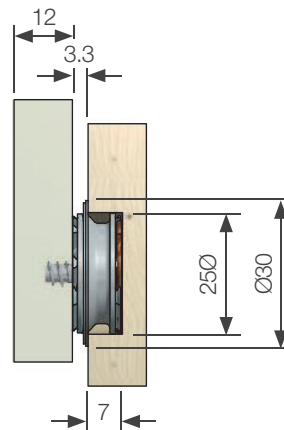

Steps: For Direct Fix

VI-F3 Surface Mount & Screw Fixed VI-M3 Screw Fixed

1. On the surface the panel is being installed onto, screw fit VL-F3 with 6-gauge screw (not supplied).
2. Insert VL-CP3 into VL-F3. This will mark the drill spot on the back of the panel.
3. Drill a 4mm/0.16" hole, 5mm/0.2" deep (with CT-09 bit) on the mark that has been created. Repeat this step depending on the number of clips required.
4. Adjust clutch to prevent over tightening.
5. Screw VL-M3 with VL-SS3 (Screw) into the panel. (Screw allows lateral movement of VL-M3)
6. Fit clips at maximum 300mm/11.8" centres on the panel.
7. Place the panel next to the wall. Position Fast Mount clips to press and lock the clip.

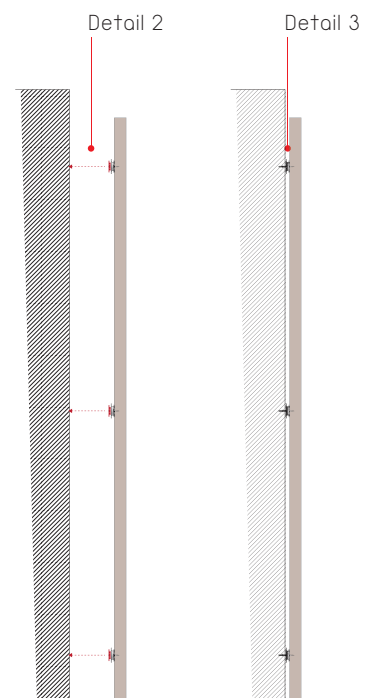
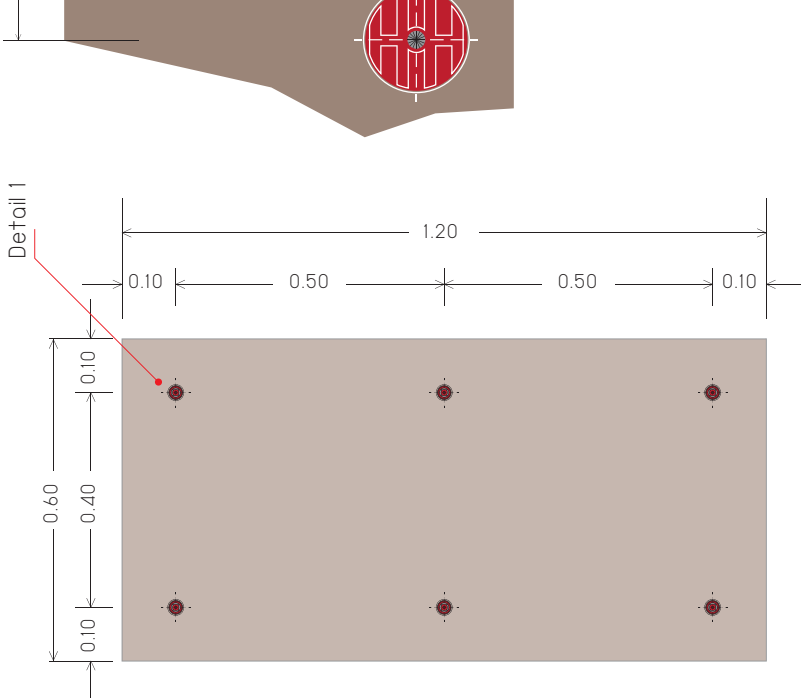
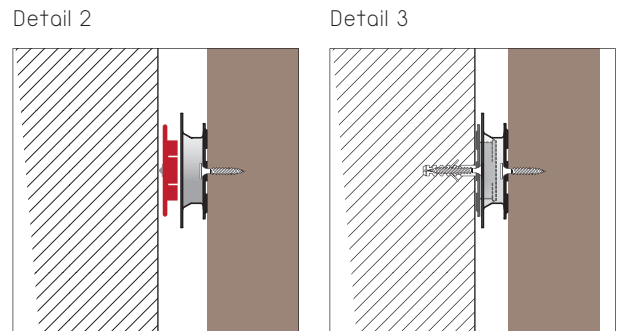
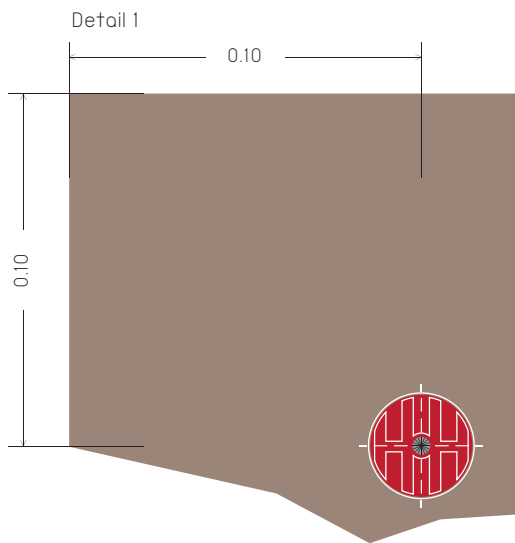
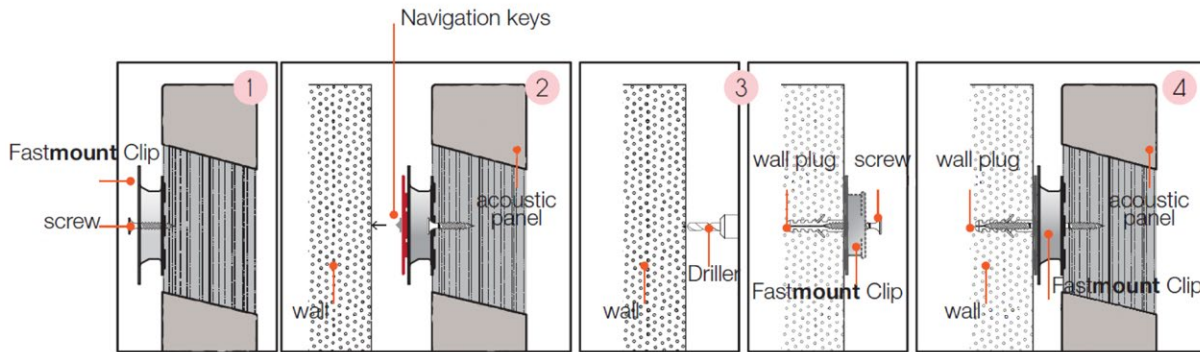



Magnet Method

Tools & materials required:

- Clean gloves
- Utility knife
- Straight edge
- Measuring tape
- Drill
- 2 x wall plugs (recommended Twist-n-Lock)

Provided with panels:

- 2 x 10-gauge 50mm/2" screws
- 2 x Metal L-Plates
- 8 x 12mm/0.47" (20mm/0.79" air gap) or 3mm/0.12" (12mm/0.47" air gap) thick Wooden Discs with magnets
- 2 x 12mm/0.47" (20mm/0.79" air gap) or 3mm/0.12" (12mm/0.47" air gap) thick Wooden Discs without magnets
- 16 x 24mm/0.94" (20mm/0.79" air gap) or 6mm/0.24" (12mm/0.47" air gap) thick Wooden Discs
- Stencil Frame
- Tensor Grip L12 adhesive spray
- 3 x 670mm/2'2.4" plank per panel

Steps:

1. Place the stencil on the wall where the panels are going to be installed. Use the stencil to mark out the locations on the required install areas.
2. Spray the L12 Adhesive on the back of both 12mm/0.47" and 24mm/0.94" wooden discs.
3. Using the L12 adhesive spray, spray the adhesive onto locations where wooden discs will be placed (as per figure 1). Ensure a 10cm/4" gap between wall and can when spraying.
4. Leave the adhesive spray to tac for 2 minutes.
5. Place the steel L plate at the bottom right-hand and left-hand side of the wall where the panel will sit. Drill the 50mm/2" screw into the magnet, smaller wooden discs without magnets, and the L-plate into the wall (as per figure 2). Repeat this step for both left and right bottom corner of the panels. No adhesive is required for this step.
6. Using L12 adhesive, glue the wooden discs with magnets onto the wall in the designated spots on the outer edge of the panels (as per figure 1).
7. Using L12 adhesive, glue the larger wooden discs without magnets to the wall in the designated spots (as per figure 1).
8. Once the wooden discs are in place, align the panel to the wall and secure into position.

Figure 1

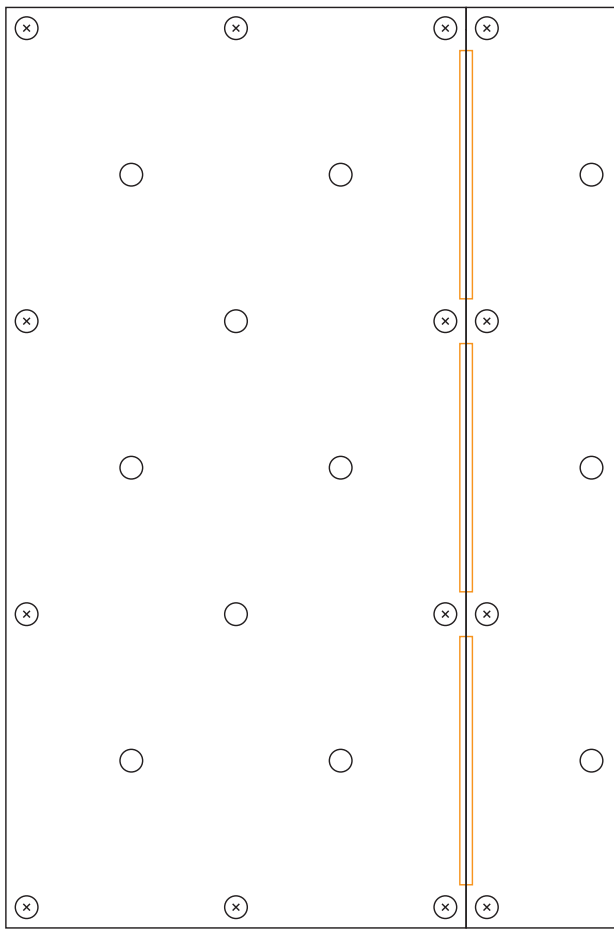



-  Wooden disc with magnet
-  Wooden plank
-  Wooden disc

Figure 2

Placement of bottom magnet with L shape bracket.

Objects not to scale.

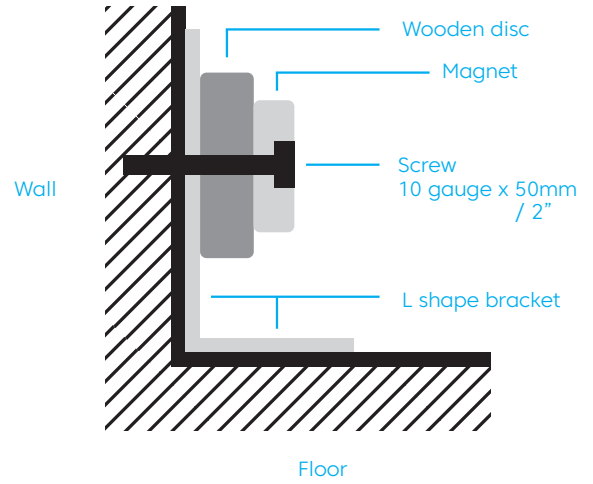

Corners & Bends

Tools & materials required:

- Utility knife/cutting tool
- Measuring tape/ruler

Steps:

1. Measure the corner of the wall/column and ensure the panels will fit seamlessly. Consider the extra panel surface area needed when bending around a corner.
2. Identify and mark the centre line for the groove on the back of the panel to align with the corner edge of wall/column. Measure parallel lines equal distance on either side of this centre line to indicate where to cut the v-shaped groove (see figure 1). The appropriate size of the groove varies depending on the panel thickness. For AP12 (12mm/0.47" acoustic panel), a total width of 2cm/0.78" (1cm/0.39" either side of centre) is suitable.
3. On the edge of the panel, mark the 'v', with the tip 2mm/0.08" from the front surface of the panel (see figure 2).
4. Use a utility knife or a cutting tool to gently cut the v-groove and remove material (see figure 3). Gradually expand the 'v' if required.
5. Bend panel and fix to wall with desired mounting method (see figure 4).

Figure 1.

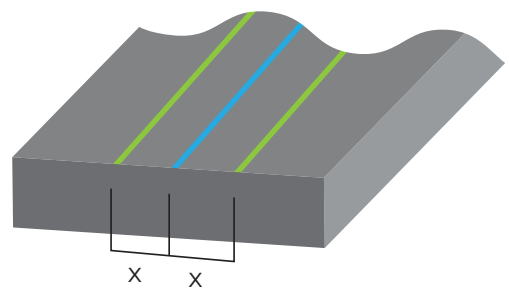

Figure 2.

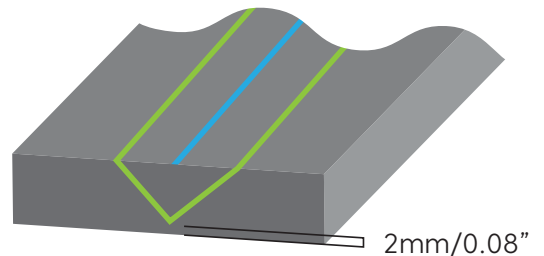

Figure 3.

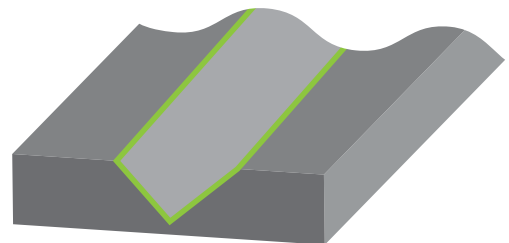
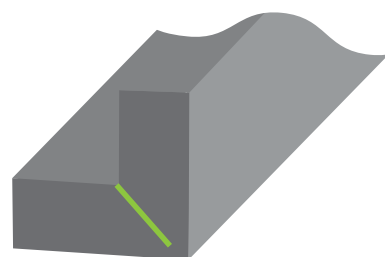

Figure 4.



acoufelt
making quiet

acoufelt.com